

***A**anime **D**estiny*

2013



***P**rogram **G**uide*



TABLES OF CONTENTS

PANELS & EVENTS.....	02
GAMING.....	03
DEALERS.....	03
ARTISTS.....	03
CONVENTION RULES.....	03
BADGE POLCY.....	05
COSPLAY GUIDELINES....	05
MAPS.....	07
SCHEDULE.....	09

Panels Descriptions:

Fansubbing for Dummies

11am-12pm

Fansubbing veterans Doremi-fansubs presents an overlook on the whole fansubbing process, including a demo on translation, timing, encoding, and release distribution. A complete history on the evolution of fansubs will also be presented, from 2000 to 2013.

Karaoke

12-1pm

Do you catch yourself singing along to catchy anime openings or have dreams of becoming a idol in Akihabara? Join your fellow fans in singing your favorite songs in this unique karaoke-club experience! Our system features the Joysound song library with over 80,000 songs ranging from idol groups such as AKB48 to recent anime theme songs and even Western pop songs. Attendees from all age groups and fandoms are sure to find a song they enjoy singing!

Wotagei Workshop

1-2pm

Come learn about Wotagei! This workshop will demonstrate for you the moves often seen at idol concerts. The panelists will then teach you the very same moves and you can join in the fun!

Angel Hearts

2-3pm

Angel Hearts is an American cosplay group based in California that specializes in idol-pop song and dance routines. They have been doing IDOLM@STER, ParaPara, and J-pop performances at anime conventions throughout California since 2003.

It's Just Porn: Hentai Scanlation

3-4pm

[18+ only]

Amateur translator Death-Panda explains the workings of erotic manga scanlation as it exists today. The presentation encompasses the work involved in the craft, the various quirks of dealing with pornographic content, and an overview of the community's composition and dynamics - a view from the pro-

duction side of something that is simultaneously the niche of maniacs and an integral part of overseas otaku culture.

CAnime Jeopardy!

4-6pm

Think you know all there is to know about anime? Come to Anime Jeopardy and put your anime knowledge to the test. Questions will range from voice actors to name that anime. Compete against other anime brainiacs to see if you can come out as number 1! If competing isn't your style you can always watch and cheer on your friends!

Cosplay Masquerade Contest

6-7pm

A convention cannot be completed without the cosplayers showing off their fabulous works.

Board Gaming:

Kill the Monsters, Steal the Treasure, Karate Chop Your Buddy!

Come join us for Munchkin Fu, eight other Munchkin variations, and all the rest of the board

games we have for you to play in the Board Game Room. We'll teach you to play Apples to Apples and see who associates what words with which (often very wrong but funny) ideas; join us for some Killer Bunnies or Zombies mayhem, lose yourself in Betrayal At House On The Hill, let us show you the new variations of Risk, and even play great out of print games like Star Trek NG.

A valid photo ID is required to check out games and borrowed games must remain in the room at all times. We also welcome people bringing their own games and decks of Magic the Gathering or other card games to play; Yugioh decks will be available for checkout.

Dealers Hall:

You can never have too much swag. Come to the dealer's hall to buy more of the anime trinkets you KNOW you need. The Dealer's hall is open from 10am-6pm, on the first floor.

Artist Alley:

Come swing by artist alley

to check out some prints, bookmarks, buttons, and more all by your favorites local artists. Artist Alley is open from 10am-6pm, on the first floor.

General Policies:

All attendees are expected to follow University of California campus policy regarding general behavior and conduct. No weapons, nudity, or drinking on the grounds of the convention is allowed. Moreover, full compliance with instructions given either by Anime Destiny staff or UCPD is expected at all times within campus grounds.

Building Policy does not allow large groups to congregate in hallways, for this reason please refrain from lingering and photographing in hallways. Noisy groups will be asked to move into the main halls. Taping posters, signs, merchandise, or any objects onto the walls of the buildings is strictly prohibited. Any violation of this policy will result in a \$25 fine. Some areas of the building are off limits; these areas are marked on the Con Map.

In case of confusion please defer to con staff for directions.

Alcoholic beverages and tobacco products may not be advertised or promoted either (a) on the Berkeley campus or (b) at off-campus activities or events sponsored by campus units or campus- recognized groups and attended by students. Campus-recognized groups include organizations of students, employees, or alumni that are registered with the campus or that use the name of either the University of California or the Berkeley campus. Moreover, Anime Destiny will not tolerate any consumption or possession of alcoholic beverages by any attendee while at the convention. All infringements upon this regulation will be reported to the appropriate legal and University administrative authorities.

Lewd or sexually offensive conduct, including indecent exposure and public nudity, is not permitted on campus. This applies to all public areas of the campus except for specifically designated "clothing optional areas" at gym-

nasiums, pools, or other areas. It applies to all persons, including students, employees, and visitors, except for babies and young children. The policy does not apply to individuals or groups participating in appropriate visual or performing arts productions or academic programs or classes, although whenever possible, members of the public should be informed that nudity may be included in the performance.

All members of the campus community are encouraged to contact the Title IX Compliance Coordinator (Sexual Harassment Officer) if they observe or encounter conduct that may be subject to the University's Policy on Sexual Harassment. Reports of sexual harassment may be brought to the Title IX Compliance Coordinator, to a human resources coordinator, or to any manager, supervisor, or other designated employee responsible for responding to reports of sexual harassment. If the person to whom harassment normally would be reported is the individual accused of harass-

ment, reports may be made to another manager, supervisor, human resources coordinator, or designated employee. Managers, supervisors, and designated employees are required to notify the Title IX Compliance Coordinator when a report is received.

Badge Policy:

Please note the following:

All props/weapons must be cleared with Con-Ops Metal-bladed Prop Weapons, which include any display of live steel, or Prop Weapons

Badges are not transferable. Lost badges can be replaced at the registration desk for \$5. We reserve the right to refuse admission to anyone.

Unless specifically noted below, a badge and/or registration record is required to attend Anime Destiny events.

Cosplay Policies:

All costumes must be decent to wear in public.

Please refrain from reckless use of props. If a problem is reported to the convention staff,

your prop will be confiscated.

If, at any time, convention staff finds your costume inappropriate in any way, you will be politely asked to change out of the costume. An inappropriate costume is one that fails to meet decency standards, blocks hallways, or causes staff or other attendees to have valid complaints.

Failure to comply with a staff request will result in the revocation of your badge. Your registration will not be refunded, and you will be escorted from the convention grounds.

If we confiscate your costume materials, they will be held at Con-Ops for you to pick up later.

All props/weapons must be cleared with Con-Ops

Metal-bladed Prop Weapons, which include any display of live steel, or Prop Weapons which may present a danger to others, may not be displayed. No props may have any sharp edges or sharp pointed tips. No items over seven (7) feet in any direction or weighing over fifteen (15) lbs will be allowed.

Water pistols are allowed

provided they are brightly colored (white, bright red, bright orange, bright yellow, bright green, bright blue, bright pink, or bright purple) and must remain EMPTY.

Weapons are not allowed to be swung, jabbed, thrust, or actively used on the convention grounds or in parking lots. Doing so can injure others and create unsafe situations. Futuristic Replicas of non-existent weapons may be displayed, provided that they are immediately and obviously recognizable as such. Examples include phasers, ray guns, or light-sabers.

COSTUMES THAT MAY BE CONFUSED WITH LOCAL LAW ENFORCEMENT OR OTHER EMERGENCY RESPONSE PERSONNEL UNIFORMS ARE NOT PERMITTED AT ANIME DESTINY.

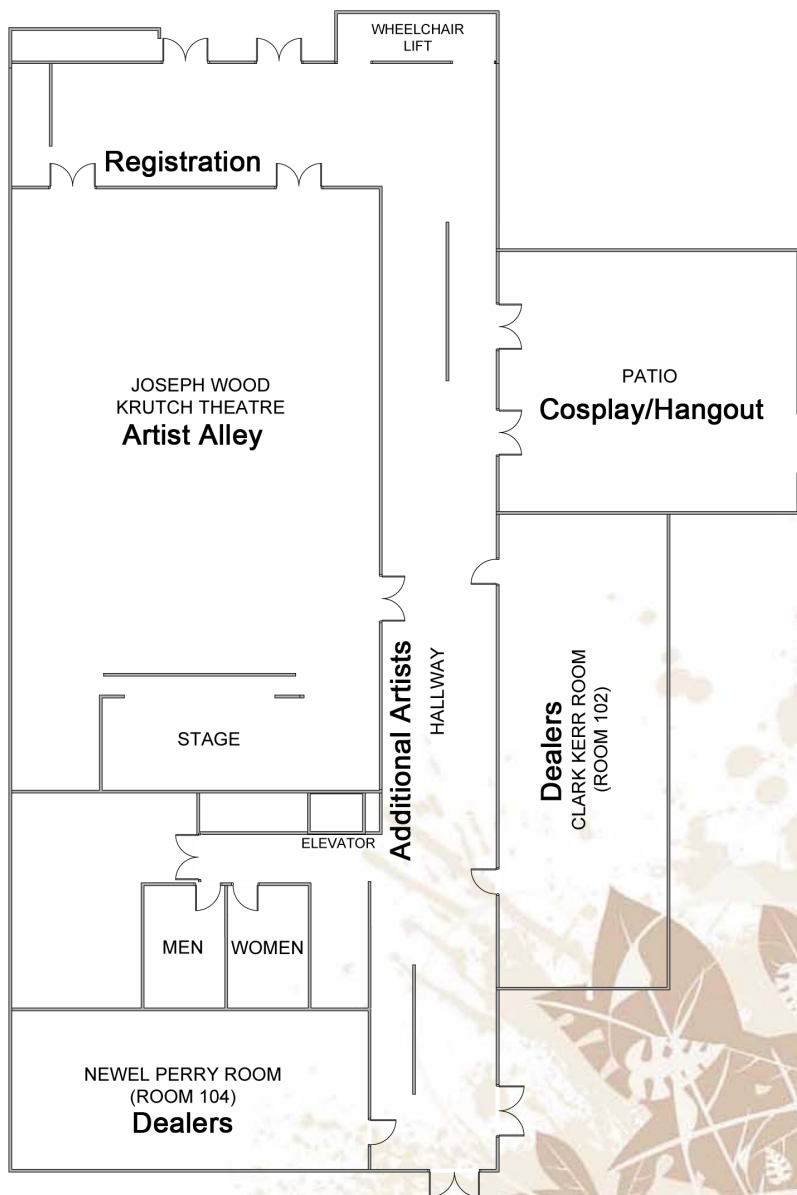

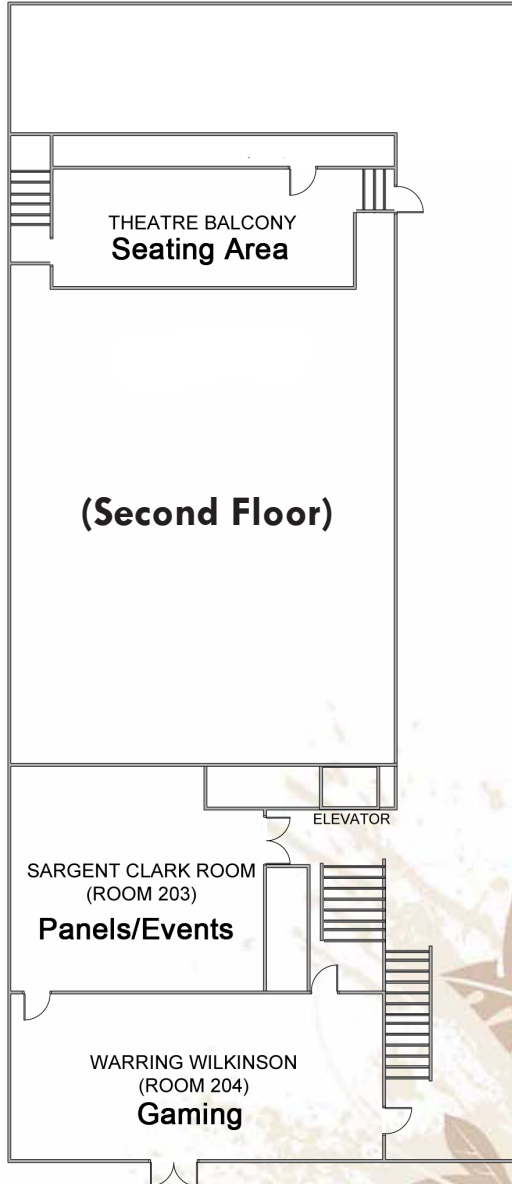

Panel Schedule:

10:00am-11:00am	[Anime Showings]
11:00am-12:00pm	Fansubbing for Dummies
12:00pm-1:00pm	Karaoke
1:00pm-2:00pm	Wotagei Workshop
2:00pm-3:00pm	Angel Hearts
3:00pm-4:00pm	It's just Porn: Hentai Scanlation [18+]
4:00pm-6:00pm	Anime Jeopardy
6:00pm-7:00pm	Cosplay Masquerade

Dealers Hall and Artist Alley Hours:

10:00am - 6:00pm

Game Room Hours:

10:00am-7:00pm

Loved Anime Destiny?

Then join us for FREE Weekly Events
on the UC Berkeley Campus

Sketching Every Monday 7:00 - 10:00 pm

Manga Social Thursdays 5:30 - 8:30 pm

Game Night Thursdays 7:30 - 10:00 pm



calanimagealpha.com

facebook.com/groups/calanimagealpha

Cal Animage Alpha

official anime club of uc berkeley

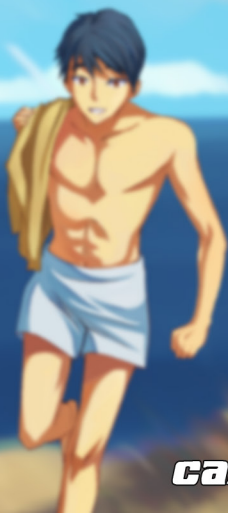

calanimedestiny.com